

1

2

3

4

5

REVISION TABLE

REV	ECN#	DESCRIPTION	REV BY	APPROVED	DATE
---	---	Original Drawing	OOG	MPW	8-28-18

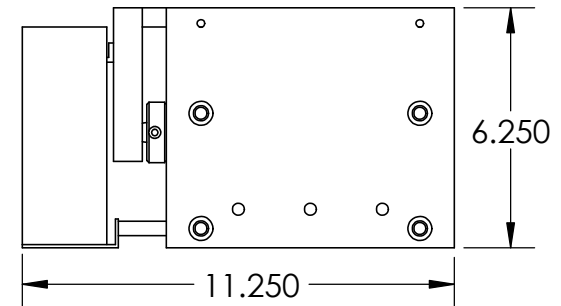
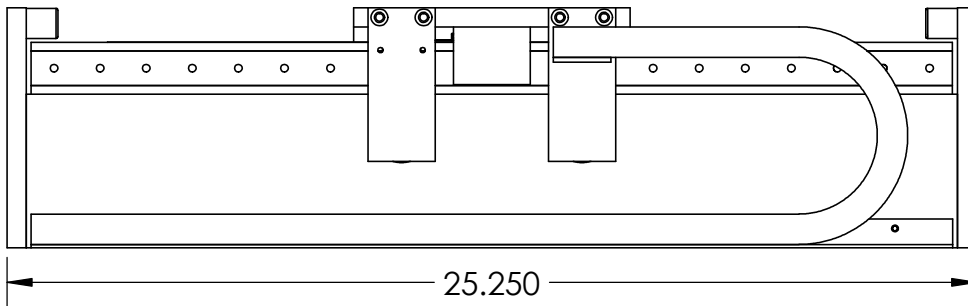
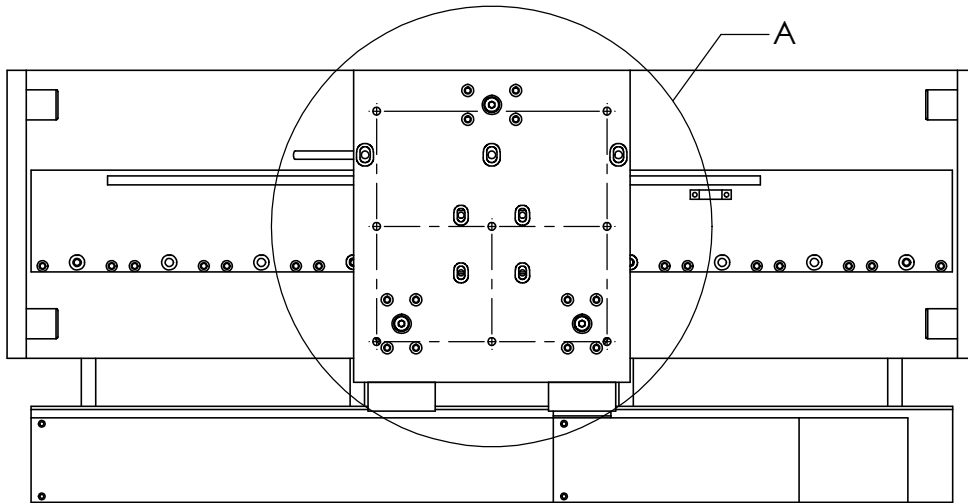

H2W Technologies, Inc.
Santa Clarita, CA 91350 USA
Tel: (661) 291-1620
www.h2wtech.com

These drawings and specifications are the property of H2W Technologies, Inc. They are issued in confidence and shall not be reproduced, copied, or used without written permission from H2W Technologies, Inc.

UNLESS SPECIFIED OTHERWISE:
All dimensions are in inches
Standard Tolerances are as follows
.XXX ±.005 ANGLES ±.1°
.XX ±.010 FILLETS .010
.X ±.020 CORNERS .010
Remove All Burrs and Sharp Edges

**FOR
REFERENCE
ONLY**

MATERIAL

FINISH

TITLE

ABS-015-09-030-X

DWG #

43-0207

REV

DATE

8-28-18

SHEET

1 of 3

MOUNTING FEATURES

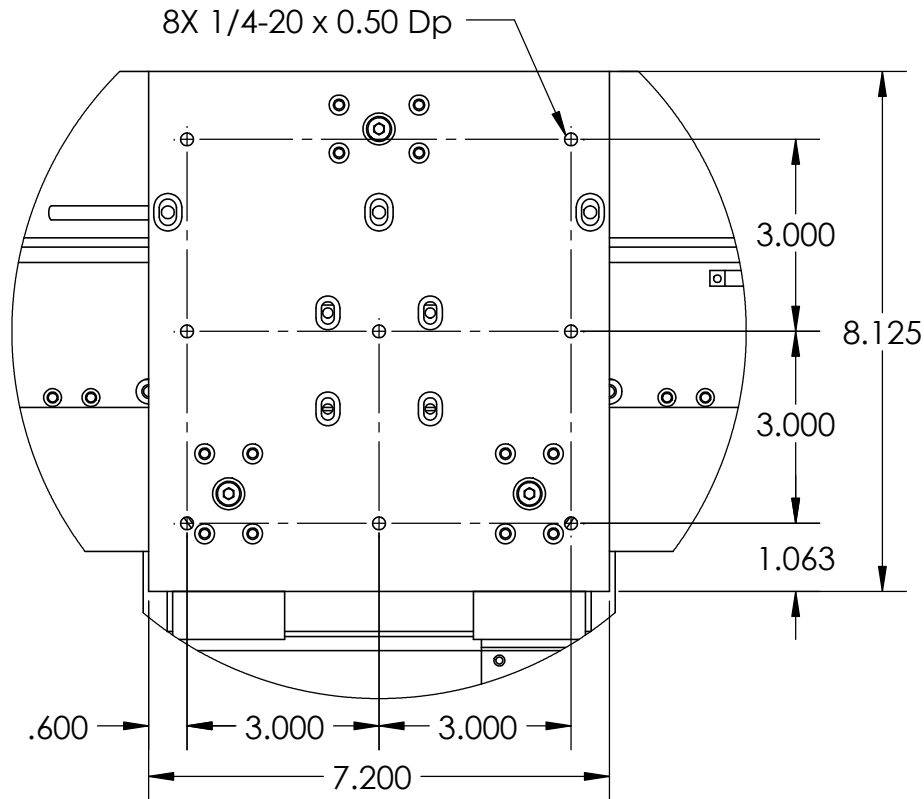

DETAIL A
SCALE 1 : 3

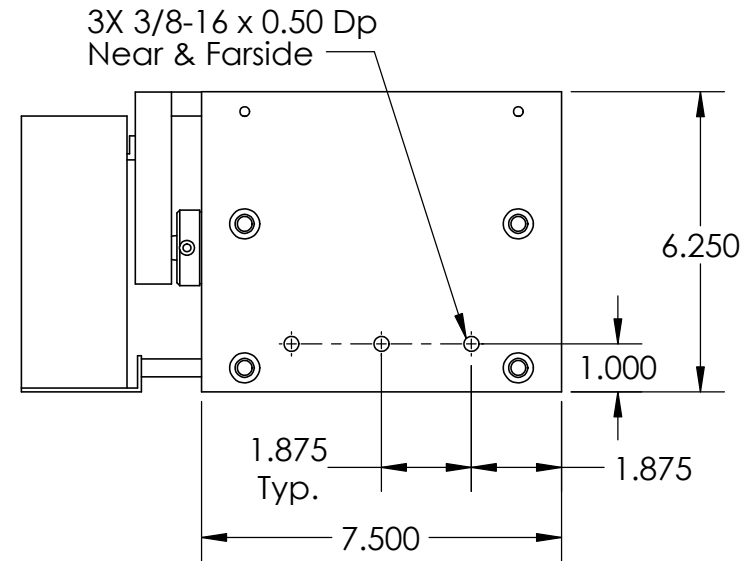

H2W Technologies, Inc.
Santa Clarita, CA 91350 USA
Tel: (661) 291-1620
www.h2wtech.com

These drawings and specifications are the property of H2W Technologies, Inc. They are issued in confidence and shall not be reproduced, copied, or used without written permission from H2W Technologies, Inc.

UNLESS SPECIFIED OTHERWISE:
All dimensions are in inches
Standard Tolerances are as follows
.XXX ±.005 ANGLES ±.1°
.XX ±.010 FILLETS .010
.X ±.020 CORNERS .010
Remove All Burrs and Sharp Edges

**FOR
REFERENCE
ONLY**

MATERIAL

FINISH

TITLE

ABS-015-09-030-X

DWG # **43-0207**
REV ----
DATE 8-28-18 SHEET 2 of 3

1

2

3

4

5

A

B

C

D

A

B

C

D

SINGLE RAIL POSITIONING STAGE SPECIFICATIONS

Motor P/N	BLDM-D06	
Stroke	15.2 in	386 mm
Encoder Resolution	1 micron	
Bearing Type	Air Bearing	
Moving Mass	6.5 lbs	3.0 kg
Total Mass	96.0 lbs	43.5 kg
Resistance @ 20C	27.3 ohms	
Inductance @ 20C	48.3 mH	
Electrical Time Constant	1.3 msec	
Motor Constant	3.2 LBS/SQRT(Watt)	14.2 N/SQRT(Watt)
Force Constant	16.7 LBS/Amp	74.4 N/Amp
Back EMF	1.9 V/ips	47.4 V/m/sec
Force @ 100% Duty	24.8 lbs	110 N
Power @ 100% Duty	77.6 watts	
Current @ 100% Duty	1.5 amps	
Force @ 10% Duty	74.5 lbs	331 N
Power @ 10% Duty	698 watts	
Current @ 10% Duty	4.4 amps	
Stage Length	25.25 in	641.4 mm
Stage Width	11.25 in	285.8 mm
Stage Height	6.25 in	158.8 mm

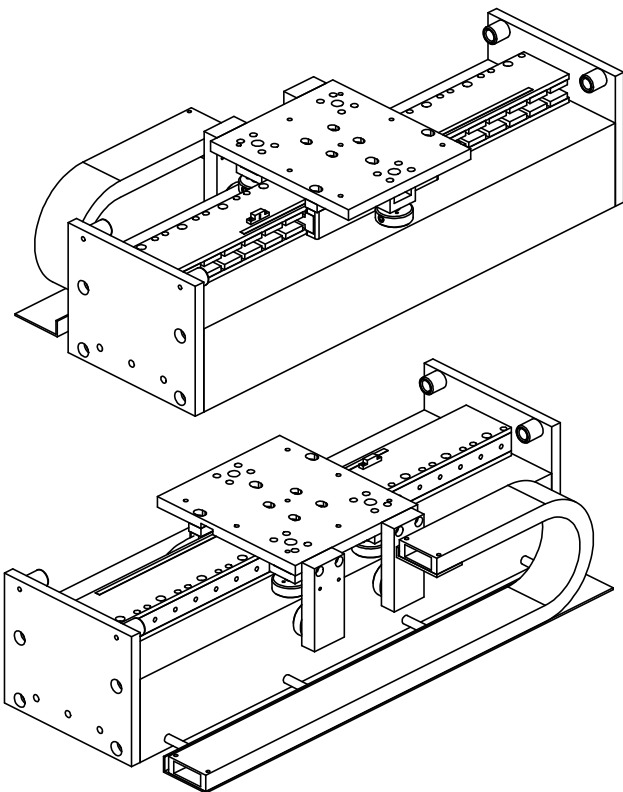

H2W Technologies, Inc.
 Santa Clarita, CA 91350 USA
 Tel: (661) 291-1620
www.h2wtech.com

These drawings and specifications are the property of H2W Technologies, Inc. They are issued in confidence and shall not be reproduced, copied, or used without written permission from H2W Technologies, Inc.

UNLESS SPECIFIED OTHERWISE:
 All dimensions are in inches
 Standard Tolerances are as follows
 .XXX ±.005 ANGLES ±.1°
 .XX ±.010 FILLETS .010
 .X ±.020 CORNERS .010
 Remove All Burrs and Sharp Edges

**FOR
 REFERENCE
 ONLY**

MATERIAL

FINISH

TITLE

ABS-015-09-030-X

DWG #

43-0207

REV

DATE

8-28-18

SHEET

3 of 3